

# 润金科技

RUUK

M

宁波市

润金机电科技有限公司

KH

宁波市 润金机电科技

有限公司







1 宁波市 润金机电科技有限公司

2

3

4 KH1512 KH1509 KH1209 KH0906 ,

5

1-1	-----	4
		4
1-3	-----	4
1-4	-----	5
1-5	-----	6
1-5-1	-----	7
1-5-2	-----	7
1-5-3	-----	7
1-6	-----	8
1-7	-----	8
1-7-1	-----	8
1-7-2	-----	8
2-1	-----	10
2-2	-----	10
2-3	-----	11
2-3-1	-----	11
2-3-2	-----	12
2-4	-----	13
2-4-1	 -----	13
2-4-2	 -----	14
2-4-3	 -----	14
2-4-4	 -----	15
2-4-5	 -----	15
2-4-5-1	 -----	15
2-4-5-2	 -----	16

1

5 40  
1 75

AC220V+10%

8A

A:

B:

C

1-1

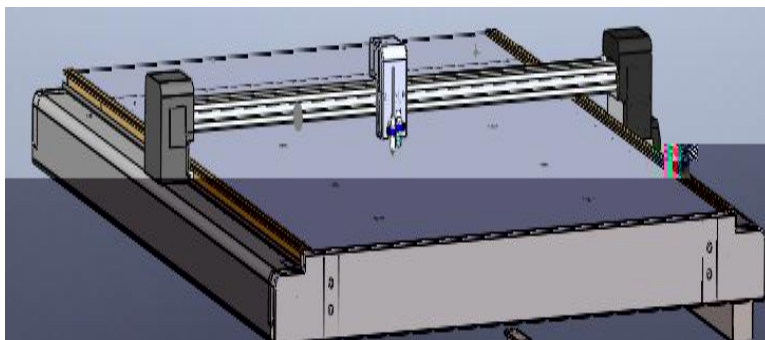

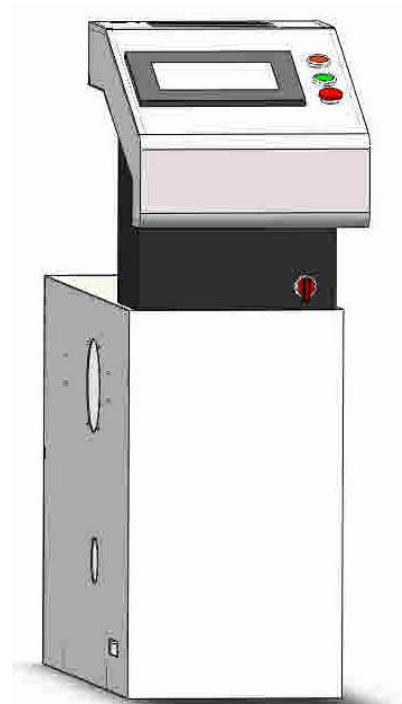
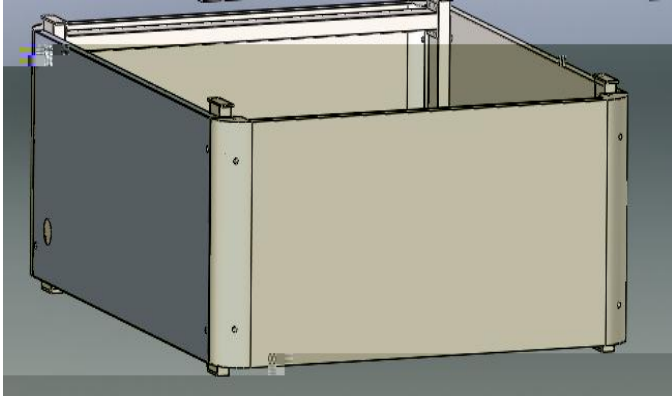

1-1

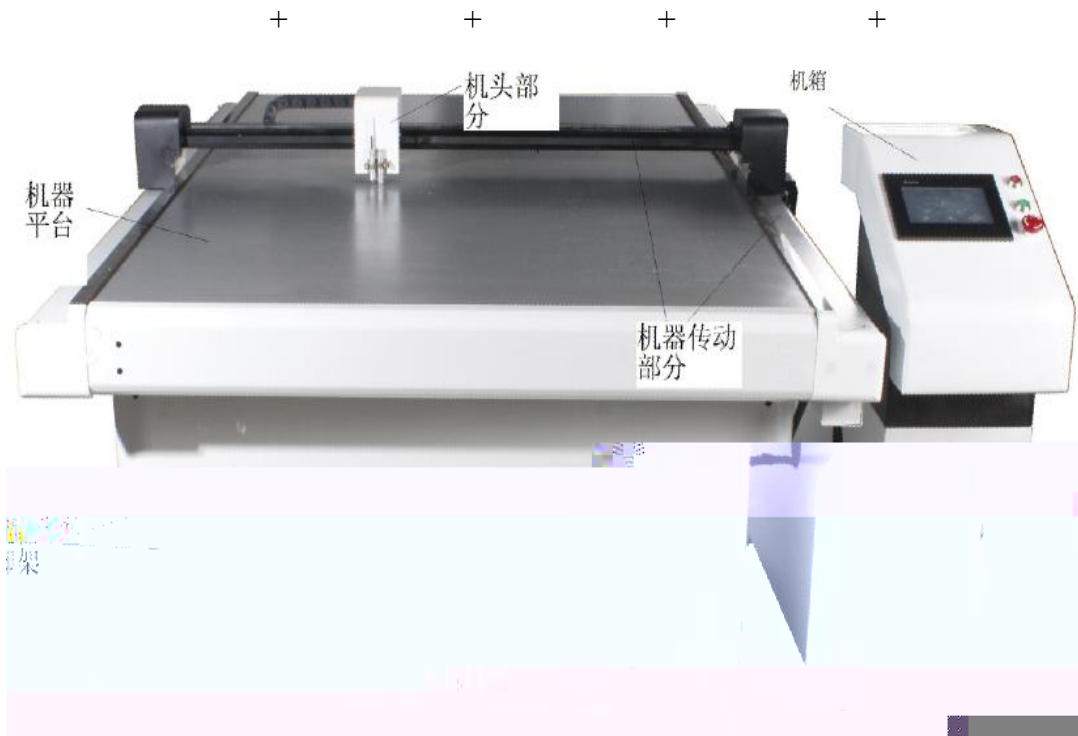

1-2

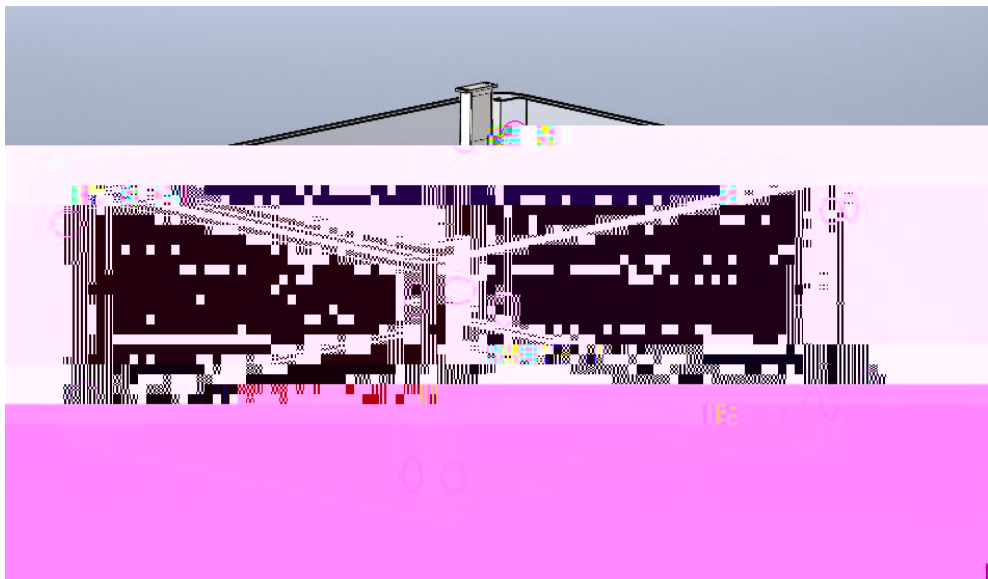

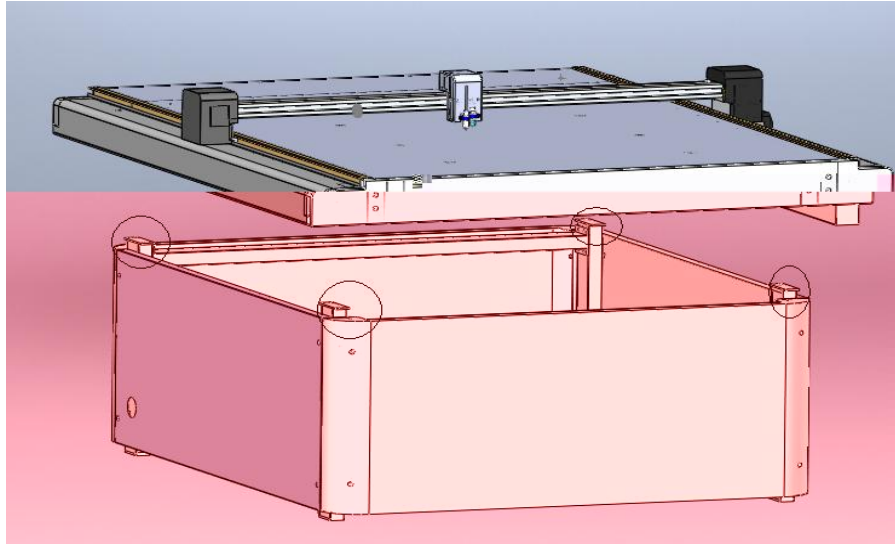

1-4

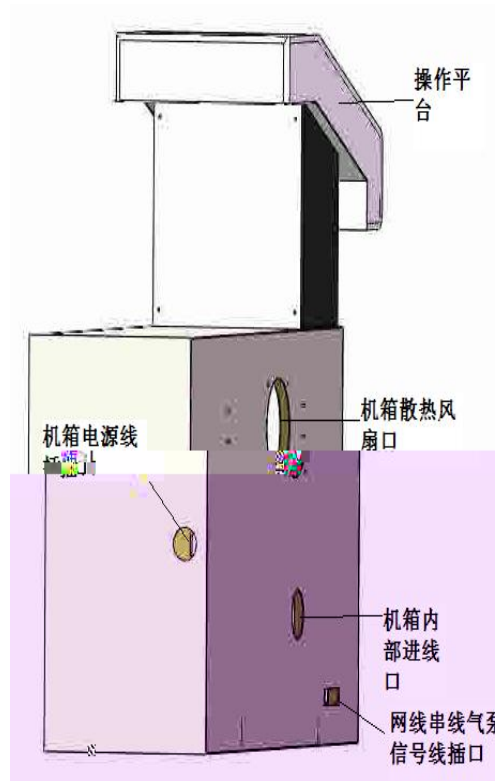
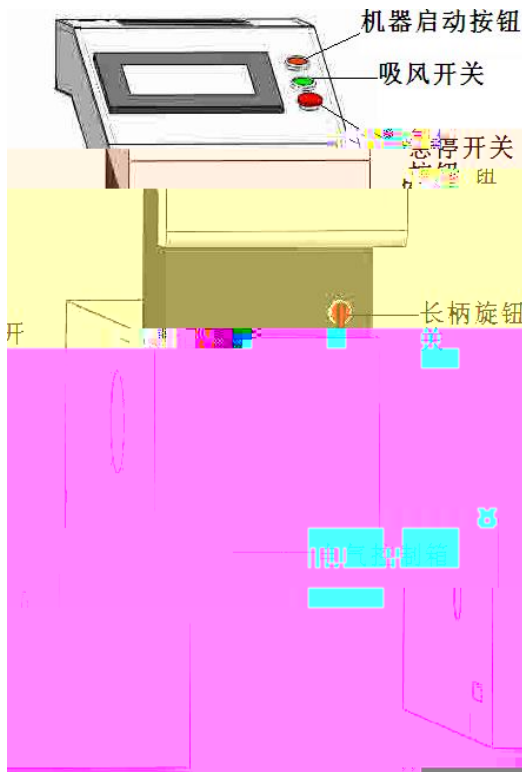

1 5

A

B

9

- 1
- 2
- 3
- 4
- 5
- 6

220V+10% 50Hz 2kW  
220V+10%

10

2

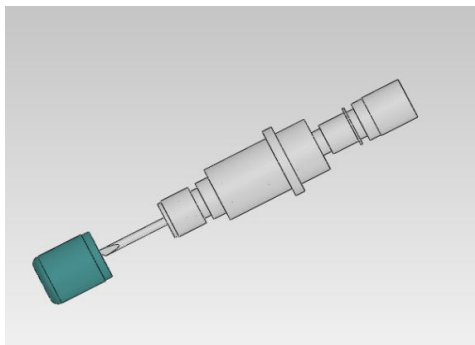

1 6

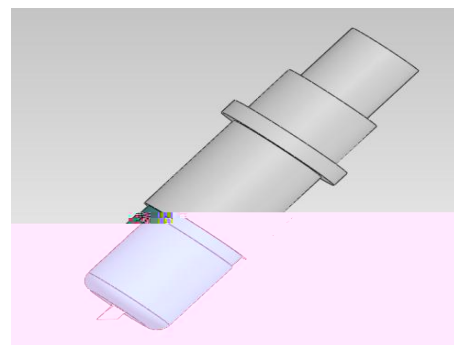

1-6

1-7

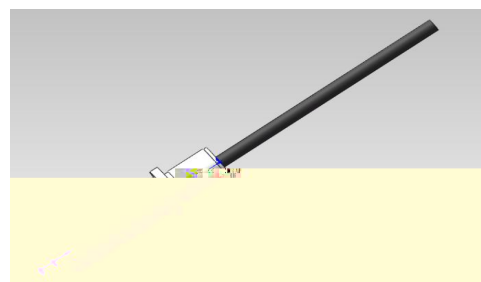
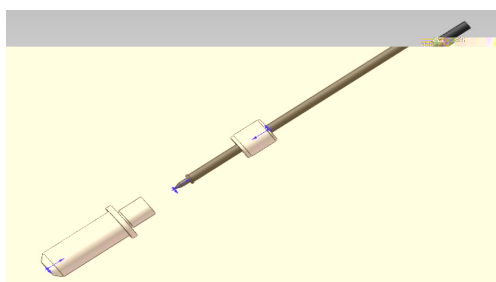

1-7

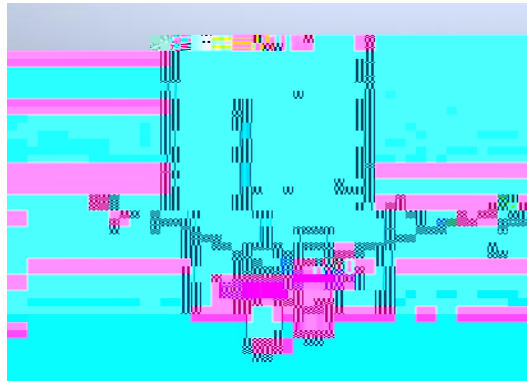

1-8

" ON"





2-4-5



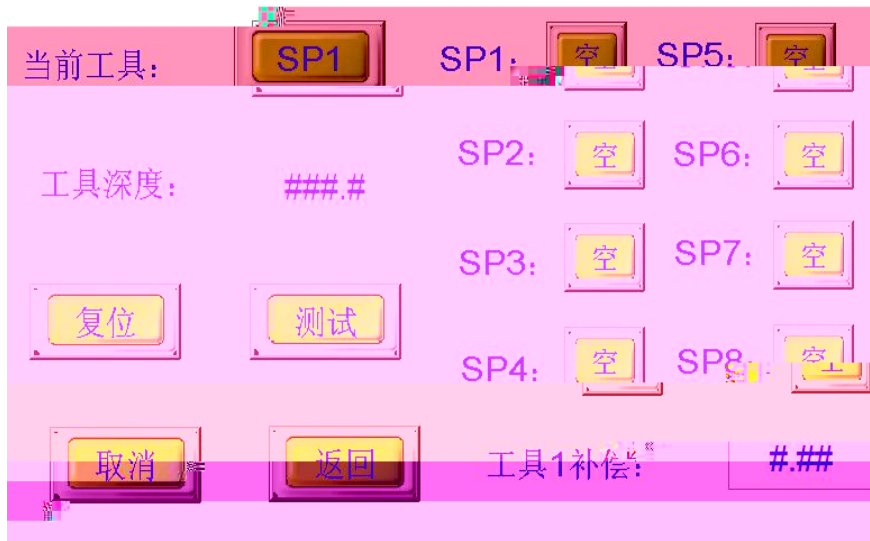

1 8

1 8

1 " " 2 " " " 空 " 1 " "

2 " "







当前工具:  SP1:  SP5: 

工具深度:  SP2:  SP6: 

  SP3:  SP7: 

  工具1补偿:  SP4:  SP8: 

“ ” 2  2

“ ” 3.0 



20\*20

CAD

2-3-1



测试速度: 





工具测试

当前工具: SP1

工具深度: 3

复位 测试

SP1: 空 SP5: 空

SP2: 空 SP6: 空

SP3: 空 SP7: 空

SP4: 空 SP8: 空

取消 返回 工具1补偿: 0.5

试刀

25CM

取消

返回

复位

刀动作

气囊

临时原点

返回

气泵

复位

重复切割

系统设置

参数设置

功能设置

高级设置

返回

参数设置

笔速:	####	下笔延迟:	###	z轴偏移:	###.#
笔加速:	#####	拾笔延迟:	###	y轴偏移:	##.#
刀速:	####	下刀延迟:	###		
刀加速:	#####	拾刀延迟:	###		
空速:	####	x校正:	###		
空加速:	#####	y校正:	###		

返回



功能设置

### 功能设置

自动重复:	<input type="button" value="关"/>	虚线切割:	<input type="text" value="###"/>	<input type="button" value="关"/>	
自动回原:	<input type="button" value="关"/>	下载端口:	<input type="button" value="以太网"/>		
IP地址:	<input type="text" value="###"/>	<input type="text" value="###"/>	<input type="text" value="###"/>	<input type="text" value="###"/>	<input type="button" value="确认"/>
系统版本号:	<input type="text" value="1.234"/>				
<input type="button" value="返回"/>					

I

3

I

I

I

3

1

2

3 5kg

4

5

6 AC220V+10% 50\60HZ 2000W

7 100 400

8

9

10

11 3

